

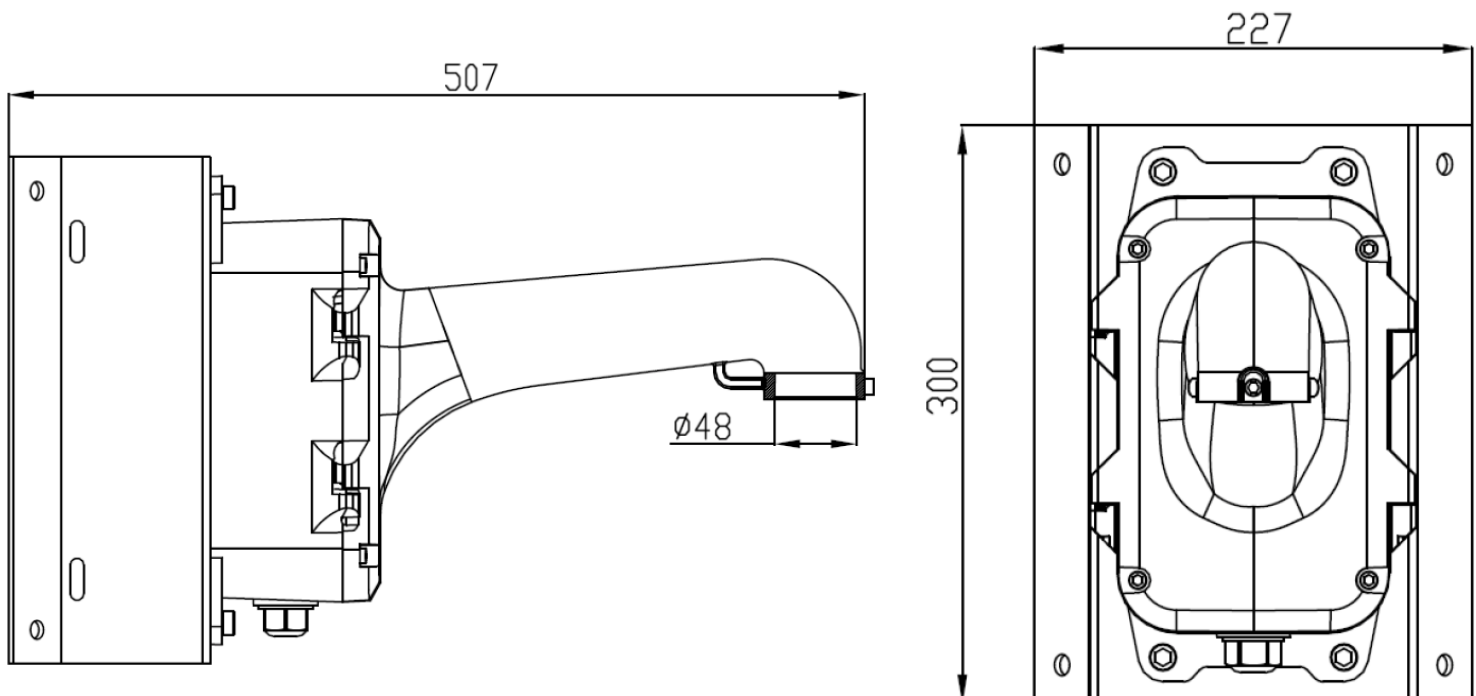

## IPM-PTZWALLJBCO

Corner mount bracket for PTZ camera with Junction box included

Model	IPM-PTZWALLJBCO
Material	Aluminum alloy and steel
Color	White
Min. Packaging Quantity	1
Packing Size	17.7 x 11.8 x 18.8 in (450x300x478mm)
Dimension	20 x 11.8 x 8.9 in (507x300x227mm)
Net Weight	14 lbs (6.3kg)
Load Bearing	The wall must be strong enough to withstand at least 3 times the weight of the speed dome and the bracket.
Working Temperature	-40°F~+140°F (-40°C~+60°C)
Working Humidity	10% ~ 90%



### Ordering Information

**IPM-PTZWALLJBCO:** Corner mount with Junction Box Included