



VIS-P4BXIR28NH-AIWL

4 Megapixel IP Plug & Play, Outdoor Turret, Fixed Lens, Up to 98' IR Range, True WDR, White Light & Deterrent, Built-in Mic/Speaker, SD Card Slot, 12VDC/PoE

Features

- True AI Human and Vehicle Classification for Line Crossing and Intrusion Detection
- White Light & Deterrent: AI Triggered
- 4 Megapixel Resolution
- Fixed Lens
- Color Image at Night with White Light Range up to 98'
- Ultra 265, H.265, H.264, MJPEG
- 30 FPS Recording and Live
- True WDR
- Micro SD Slot: Up to 256GB
- Built-in Mic
- Built-in Speaker
- IP67 Weatherproof
- 12VDC/PoE Operation
- ONVIF
- Free iOS & Android Apps for Smart Phones & Tablets
- Vision CMS
- Free MAC Client

Camera	VIS-P4BXIR28NH-AIWL				
Sensor	1/2.7", 4.0 megapixel, progressive scan, CMOS				
Minimum Illumination	Colour: 0.002 lux (F1.6, AGC ON) 0 lux with Light on				
Day/Night	IR-cut filter with auto switch (ICR)				
Shutter	Auto/Manual, 1 ~ 1/100000s				
Adjustment angle	Pan: 0° ~ 360° Tilt: 0° ~ 90° Rotate: 0° ~ 360°				
WDR	120dB				
S/N	>56dB				
Lens					
Lens type	2.8mm@F1.6				
Iris	Fixed				
Field of View (H)	101.1°				
Field of View (V)	55.3°				
Field of View (D)	111.1°				
DORI					
DORI Distance	Lens	Detect (ft)	Observe (ft)	Recognize (ft)	Identify (ft)
	2.8mm	206.7 (63m)	82.7(25.2m)	41.3 (12.6m)	20.7 (6.3m)
Illuminator					
IR Range	Up to 98 ft (30m) IR range				
Wavelength	850nm				
IR On/Off Control	Auto/Manual				
Video					
Video Compression	Ultra 265, H.265, H.264, MJPEG				
H.264 code profile	Baseline profile, Main profile, High profile				
Frame Rate	Main Stream: 4MP (2688*1520), Max 30fps; 4MP (2560*1440), Max 30fps; 3MP (2304*1296), Max 30fps; 1080P (1920*1080), Max 30fps; Sub Stream: 720P (1280*720), Max 30fps; D1 (720*576), Max 30fps; 640*360, Max 30fps; Third Stream: D1 (720*576), Max 30fps; 640*360, Max 30fps; 2CIF(704*288), Max 30fps; CIF(352*288), Max 30fps;				
Video Bit Rate	128 Kbps~16 Mbps				
U-code	Support				
OSD	Up to 8 OSDs				
Privacy Mask	Up to 4 areas				
ROI	Up to 8 areas				
Video Stream	Triple streams				
Image					
White Balance	Auto/Outdoor/Fine Tune/Sodium Lamp/Locked/Auto2				
Digital Noise Reduction	2D/3D DNR				
Smart IR	Support				
Flip	Normal/Vertical/Horizontal/180°/90°Clockwise/90°Anti-clockwise				
Dewarping	N/A				
HLC	Supported				
BLC	Supported				
Defog	Digital Defog				
Intelligent					
Smart intrusion prevention	Support false alarm filtering: Cross Line detection, Intrusion detection, Enter Area detection, Leave Area detection				
Recognition	Face capture				
Statistical Analysis	People counting, support people flow counting and crowd density monitoring				
Events					
Basic Detection	Motion detection, tampering alarm, audio detection				
General Function	Watermark, IP address filtering, tampering alarm, access policy, ARP protection, RTSP authentication, user authentication				
Audio					
Audio Compression	G.711				
Audio Bitrate	64 Kbps				
Two-way audio	Supported				
Suppression	Supported				

Sampling Rate	8KHZ
Storage	
Edge Storage	Micro SD, up to 256GB
Network Storage	ANR, NAS(NFS)
Network	
Protocols	IPv4, IGMP, ICMP, ARP, TCP, UDP, DHCP, PPPoE, RTP, RTSP, RTCP, DNS, DDNS, NTP, FTP, UPnP, HTTP, HTTPS, SMTP, 802.1x, SNMP, QoS, RTMP, SSH
Compatible Integration	ONVIF (Profile S, Profile G, Profile T), API, SDK
User/Host	Up to 32 users. 2 user levels: administrator and common user
Security	Password protection, strong password, HTTPS encryption, Export operation logs, basic and digest authentication for RTSP, digest authentication for HTTP, TLS 1.2, WSSE and digest authentication for ONVIF
Clients	InVid Vision (Mobile App) Vision Tools (IP Utility) InVid CMS
Web Browser	Plug-in required live view: IE9+, Chrome 41 and below, Firefox 52 and below Plug-in free live view: Chrome 57.0+, Firefox 58.0+, Edge 16+
Interface	
Audio I/O	N/A
Alarm I/O	N/A
RS485	N/A
Built-in Mic	Support
Built-in Speaker	Support
WiFi	N/A
Network	1 * RJ45 10M/100M Base-TX Ethernet
Video Output	N/A
Alarm Light	Support
Audio Sensitivity	102dB, Frequency: 550Hz~20KHz, Output: 2W
Certifications	
EMC	CE-EMC (EN 55032: 2015+A1:2020, EN 61000-3-3: 2013+A1: 2019, EN IEC 61000-3-2: 2019+A1: 2021, EN 55035: 2017+A1:2020) FCC (FCC CFR 47 part15 B, ANSI C63.4-2014)
Safety	CE LVD (EN 62368-1:2014+A11:2017) CB (IEC 62368-1:2014) UL (UL 62368-1, 2nd Ed., Issue Date: 2014-12-01)
Environment	CE-RoHS (2011/65/EU;(EU)2015/863); WEEE (2012/19/EU); Reach (Regulation (EC) No 1907/2006)
Protection	IP67 (IEC 60529:1989+AMD1:1999+AMD2:2013)
General	
Power	DC 12V±25%, PoE (IEEE 802.3af) Power consumption: Max 11.5W
Power Interface	Ø 5.5mm coaxial power plug
Dimensions (L × W × H)	7.5" × 3.0" × 2.9" (191 × 75 × 74mm)
Weight	1.10lb (0.50kg)
Material	Metal
Working Environment	-22°F ~ 140°F (-30°C ~ 60°C), Humidity: ≤95% RH (non-condensing)
Storage Environment	-22°F ~ 140°F (-30°C ~ 60°C), Humidity: ≤95% RH (non-condensing)
Surge Protection	4KV
Reset Button	Supported

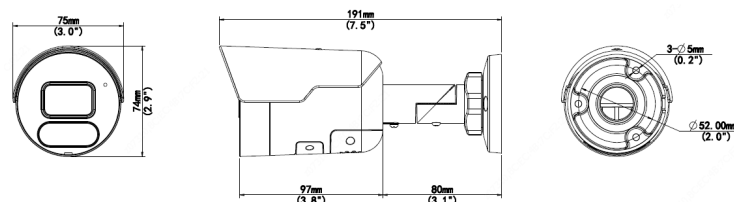

Ordering Information

VIS-P4BXIR28NH-AIWL: 4 Megapixel IP Plug & Play Outdoor Bullet, 2.8mm

InVid Tech, reserves the right to make changes to improve our products at any time without notice; we are not responsible for misprints.